

CUBICLE TRACKING AND PARTS DESCRIPTIONS

7000 SERIES

GENERAL DESCRIPTIONS

Cubicle Track

Cubicle track system shall be Diamond Drapery Model Number 7000 which is equivalent to Kirsch 7900 series complete with 1-3/8" x 3/4". 7000 Series cubicle track is extruded aluminum track channel, 6063-T5 with carriers, end stops, and other required accessories for a complete and operational track system. Inner surface is center ridged grooved for easy installation. If specified, tracks will be bent or circular curved for one continuous length up to 20 feet. Bends will have an approximate 12 inch (308mm) radius.

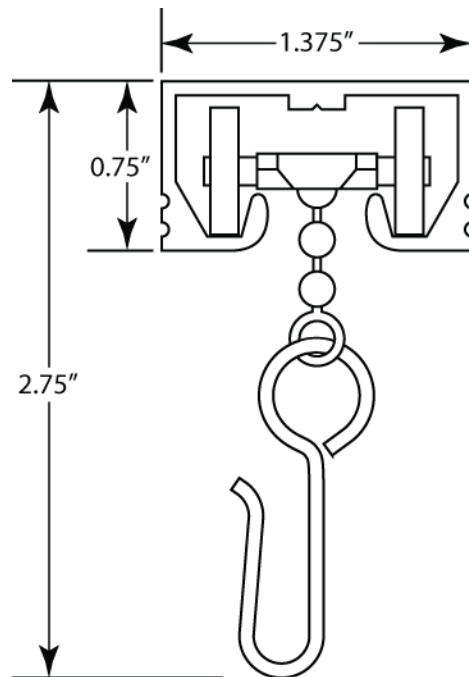

COMPONENT DESCRIPTIONS

7000-01 Carrier with Hook

Carrier shall be constructed of natural Celcon body with a nickel plated steel chain. Body is supported from two natural nylon wheels. A nickel plated steel hook is attached for curtain attachment.



7000-01BA Break Away Carrier

Carrier shall be constructed of 100% plastic molded in two pieces. The wheeled portion incorporates a through hole and the hooked portion incorporates a barbed tab. Together this hole and barb combination provide a breaking point rated at 7lbs of pull force.

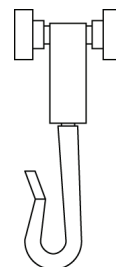

7000-01HLT Carrier with Hook and Loop Tab

Carrier shall be constructed of natural Celcon body with a nickel plated steel chain. Attached to the steel chain is a hook and loop tab designed for breakaway curtain attachment. Body is supported from two natural nylon wheels.

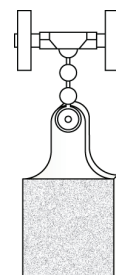

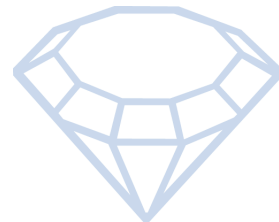

CUBICLE TRACKING AND PARTS DESCRIPTIONS

7000 SERIES

COMPONENT DESCRIPTIONS (CONTINUED)

7000-03 End Stop

End stop of .032" minimum sheet aluminum die-formed with commercial clear anodized finish.

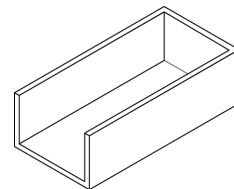

7000-04 End Stop with Pull-Out

End stops of .032" minimum sheet aluminum die-formed with commercial clear anodized finish. Pull-out of .032" minimum sheet aluminum die-formed and anodized with commercial clear finish. Plated machine screw permits removal of pull-out for access to track carriers.

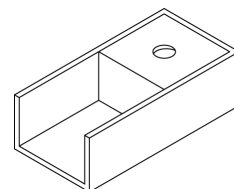

7000-05 Splice

Splice shall be made from extruded 6063-T5 aluminum with commercial clear anodized finish.

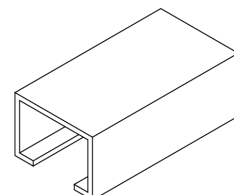

7000-06 Ceiling Bracket (for Suspension Mount)

Ceiling bracket constructed of sheet aluminum top and extruded 6063-T5 "U" channel. All aluminum parts have a commercial clear anodized finish

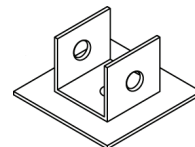

7000-07 Track End Wall Bracket (for Suspension Mount)

Wall bracket shall be made from extruded steel alloy aluminum with a powder coated finish.

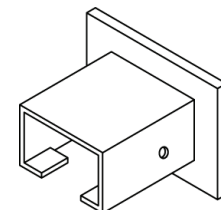

7000-08 Track Bracket (for Suspension Mount)

Track bracket shall be made from extruded 6063-T5 aluminum with commercial clear anodized finish.

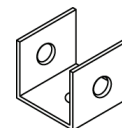

7000-11 P.V.C. 16" Drop

P.V.C. drop shall be constructed of .085" x .350" extruded white P.V.C. with attachment holes at each end. One end provided with nickel plated steel hook for curtain attachment.



7000-ST Suspension Tubing

Suspension tubing shall be made from 3/4" x 3/4" x .063" extruded 6063-T5 aluminum with commercial clear anodized finish.

