

# CUBICLE TRACKING AND PARTS DESCRIPTIONS

## 5000 SERIES

### GENERAL DESCRIPTIONS

#### **Cubicle Track**

Cubicle track system shall be Diamond Drapery Model Number 5000 complete with 1-1/8" x 3/4" extruded aluminum track channel, carriers, end stops, and other required accessories for a complete and operational track system. Track channel available either curved or straight in continuous lengths up to 20 feet. Bends will have an approximate 12" radius (305mm).

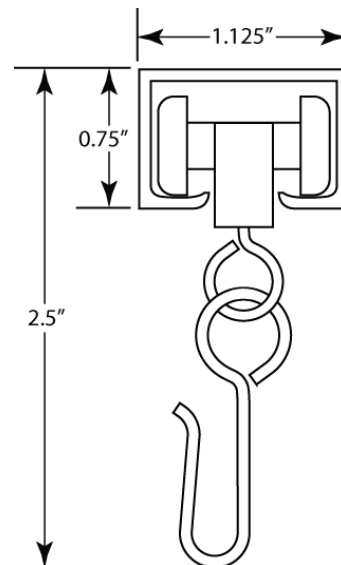

### COMPONENT DESCRIPTIONS

#### **5000-01 Carrier with Hook**

Carrier shall be constructed of natural nylon body with molded in loop and nickel plated steel hook for curtain attachment. Body supported from two natural nylon wheels fastened by plated steel rivet.



#### **5000-01BA Break Away Carrier**

Carrier shall be constructed of 100% plastic molded in two pieces. The wheeled portion incorporates a socket and the hooked portion incorporates a ball. Together this ball and socket combination provide a breaking point rated at 7lbs of pull force.

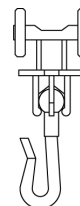

#### **5000-01HLT Carrier with Hook and Loop Tab**

Carrier shall be constructed of natural nylon body with molded in loop. Attached to the loop is a hook and loop covered tab designed for breakaway curtain attachment. Body supported from two natural nylon wheels fastened by a plated steel rivet.



#### **5000-03 End Stop**

End stop of .032" minimum sheet aluminum die-formed with commercial clear anodized finish.

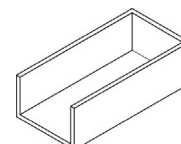

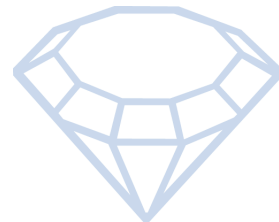

# CUBICLE TRACKING AND PARTS DESCRIPTIONS

## 5000 SERIES

### COMPONENT DESCRIPTIONS (CONTINUED)

#### **5000-04 End Stop with Pull-Out**

End stops of .032" minimum sheet aluminum die-formed with commercial clear anodized finish. Pull-out of .032" minimum sheet aluminum die-formed and anodized with commercial clear finish. Plated machine screw permits removal of pull-out for access to track carriers.

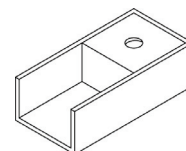

#### **5000-05 Splice**

Splice shall be made from extruded 6063-T5 aluminum with commercial clear anodized finish.

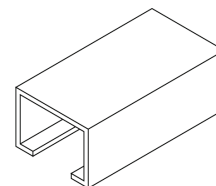

#### **5000-06 Ceiling Bracket – Suspension Mount**

Ceiling bracket constructed of sheet aluminum top and extruded 6063-T5 "U" channel. All aluminum parts have a commercial clear anodized finish.

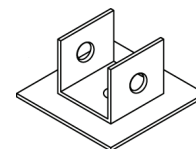

#### **5000-07 Track End Wall Bracket – Suspension Mount**

Wall bracket shall be made from extruded 6063-T5 aluminum with commercial clear anodized finish.

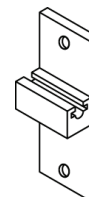

#### **5000-08 Track Bracket – Suspension Mount**

Track bracket shall be made from extruded 6063-T5 aluminum with commercial clear anodized finish.

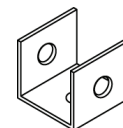

#### **5000-11 P.V.C. 16" Drop**

P.V.C. drop shall be constructed of .085" x .350" extruded white P.V.C. with attachment holes at each end. One end provided with nickel plated steel hook for curtain attachment.

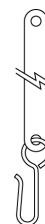

#### **5000-17 Radius Connector – Suspension Mount**

Radius connector shall be made from heavy gauge nickel steel with attachment holes throughout the center.

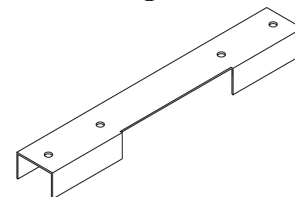

#### **5000-ST Suspension Tubing**

Suspension tubing shall be made from 3/4" x 3/4" x .063" extruded 6063-T5 aluminum with commercial clear anodized finish.

